



3 card One Sheet Wonder



This is the one sheet wonder layout I used by Sylvia Durocher.

I have used Candy Lane Designer Series Paper but of course you could use embossed card, plain coloured card or even stamp your own card to create a unique panel.

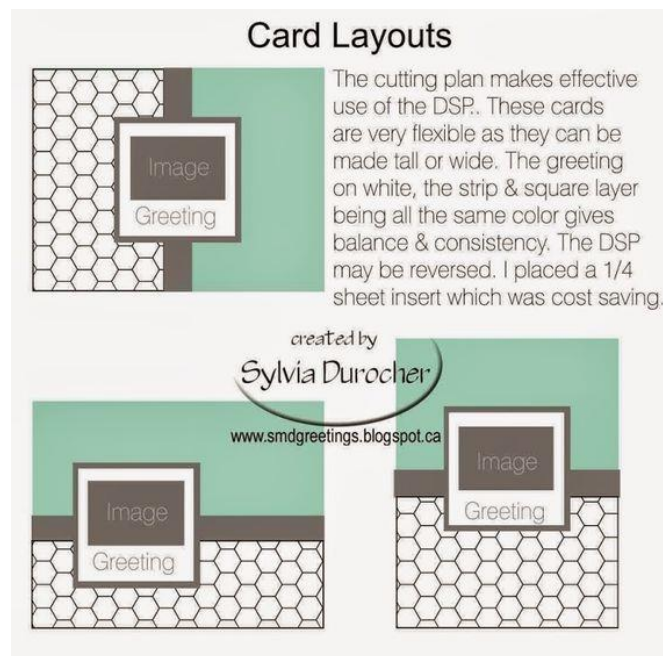
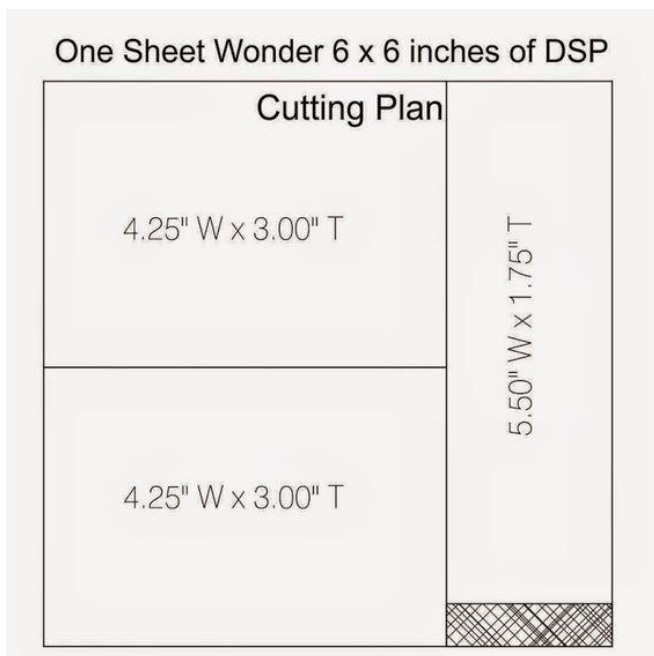

Instead of cutting the 6" x 6" piece of Designer Series Paper at 4.25", I cut it at 10cm which is the width of our cards and the remainder was used for the third card. You will need to trim this piece down to 14.3cm in length.

Card 1



1. Emboss the top half of Whisper White card 10cm x 14.3cm using the Cable Knit Embossing Folder.
2. Attach one piece of Designer Series Paper 10cm x 3" to the bottom of the embossed card.
3. Wrap the join with the Real Red Stitched Edge Ribbon.
4. Attach the panel to Real Red card 10.5cm x 29.6cm, scored at 14.8cm.
5. Stamp "Merry Christmas" onto the lower edge of Whisper White card 6cm x 8cm using Real Red ink.
6. Attach the stamped Whisper White card to Real Red card 6.5cm x 8.5cm.
7. Attach the panel to the card front using dimensionals. (I placed my dimensionals so that they wouldn't adhere to the ribbon.)
8. Stamp the reindeer image onto scrap Whisper White card using Early Espresso ink.
9. Punch out the reindeer using the Cookie Cutter Punch.
10. Attach the reindeer to the "merry Christmas" panel using dimensionals.
11. Stamp the bow image onto scrap Whisper White card using Real Red ink.
12. Punch out the bow using the Cookie Cutter Punch.
13. Attach the bow to the Whisper White card just below the reindeer image using a Glue Dot.
14. Emboss Whisper White card 10cm x 3cm using the Cable Knit Embossing Folder.
15. Attach a narrow piece of Real Red card behind one long edge.
16. Attach the embossed panel to the bottom of Whisper White card 10cm x 14.3cm.
17. Attach the panel to the inside of the card.

Card 2



1. Emboss the right hand side of Whisper White card 14.3cm x 10cm using the Cable Knit Embossing Folder.
2. Attach the second piece of Designer Series Paper 10cm x 3" to the left hand side of the embossed card.
3. Wrap the join with the Real Red Stitched Edge Ribbon.
4. Attach the panel to Real Red card 21cm x 14.8cm, scored along the 21cm length at 10.5cm.
5. Stamp "merry Christmas" onto the lower edge of Whisper White card 6cm x 8cm using real Red ink.
6. Attach the stamped card to Real Red card 6.5cm x 8.5cm.

18. Attach the "merry Christmas" panel to the card front using dimensionals. (I placed my dimensionals so that they wouldn't adhere to the ribbon.)
7. Stamp the bear image onto scrap Whisper White card using Crumb Cake ink.
8. Stamp the "eyes/nose" image onto the bear using Early Espresso ink.
9. Punch out the bear using the Cookie Cutter Punch.
10. Stamp the ears onto scrap Whisper White card using crumb cake ink.
11. Punch out ears using the Cookie Cutter Punch.
12. Attach the ears to the back of the bear's head.
13. Stamp the bow image onto scrap Whisper White card using Real Red ink.
14. Punch out the bow using the Cookie Cutter Punch.
15. Attach the bear to the "merry Christmas" panel using dimensionals.
16. Attach the bow to the bear just below his head using a Glue Dot.
17. Emboss Whisper White card 14.3cm x 3cm using the Cable Knit Embossing Folder.
18. Attach a narrow strip of Real Red card behind one long edge.
19. Attach the embossed card to the bottom of Whisper White card 14.3cm x 10cm.
20. Attach the panel to the inside of the card.

Card 3



1. Emboss the top half of Whisper White card 14.3cm x 10cm using the Cable Knit Embossing Folder.
2. Attach the remaining piece of Designer Series Paper across the bottom of the embossed Whisper White card.
3. Wrap the join using Real Red Stitched Edge Ribbon.
4. Attach the embossed panel to Real Red card 21cm x 14.8cm, scored along the 21cm length at 10.5cm.
5. Stamp "merry Christmas" onto the lower edge of Whisper White card 6cm x 8cm using real Red ink.
6. Attach the stamped card to Real Red card 6.5cm x 8.5cm.

7. Attach the "merry Christmas" panel to the card front using dimensionals. (I placed my dimensionals so that they wouldn't adhere to the ribbon.)
8. Stamp the Gingerbread image onto scrap Whisper White card using Early Espresso ink.
9. Punch out the Gingerbread image using the Cookie Cutter Punch.
10. Punch out two small Real Red card circles using the Cookie Cutter Punch.
11. Attach the Gingerbread image to the "merry Christmas" panel using dimensionals.
12. Attach the two small Real Red card circles to the Gingerbread man.
13. Emboss Whisper White card 14.3cm x 3cm using the Cable Knit Embossing Folder.
14. Attach a narrow strip of Real Red card behind one long edge.
15. Attach the embossed card to the bottom of Whisper White card 14.3cm x 10cm.
16. Attach the panel to the inside of the card.

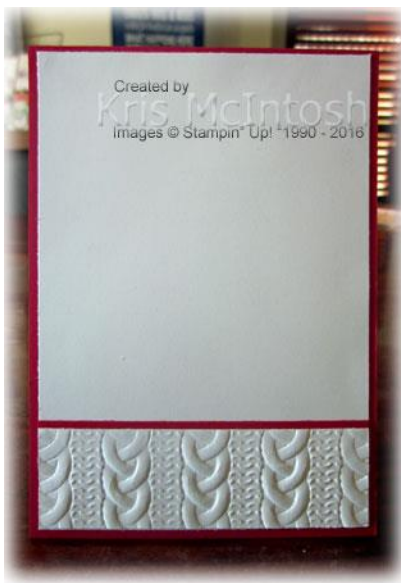

I hope you find this cutting diagram for your Designer Series Paper useful in the future.

Kris

Kristine McIntosh

Independent Stampin' Up! Demonstrator Brisbane, Australia

0429668535

krismac8@bigpond.com

Blog: www.stampingwithkris.com

Web: www.krismcintosh.stampinup.net

Facebook: <http://www.facebook.com/pages/Stamping-With-Kris/187579114586591>